

205 Watt (Black) Monocrystalline Solar Module

ZXM5-205 W is one of ZNSHINE SOLAR's most compact solar panels. Versatile and adaptable, with power output ranging from 180 Wp up to 205 Wp, it is perfect for both groundmounted and commercial rooftop systems.

During the manufacturing process of this panel rigorous quality control meets the highest international standards: ISO 9001, 14001 and 18001.

Being approved by international testing institutions like TÜV Süd, TÜV Rheinland and BABT this panel comes with a 25-year output guarantee of 80 % power production and a 10-year manufacturer warranty.



RoHS (Restriction of Hazardous Substances):

Like all other panels from ZNSHINE SOLAR this fulfills all restrictions regarding the use of Lead, Mercury, Cadmium, Hexavalent Chromium, PBB or PBDE. Therefore, you can be sure about one thing: We take our green mission very responsibly.

25 years power output guarantee insured by the PowerGuard insurance

As one of the first manufacturers worldwide all modules from ZNSHINE SOLAR are equipped with the new PowerGuard insurance. This means you can rely on an



insured output of 90 % for 10 years and 80 % for 25 years. More security cannot be achieved by any other insurance!

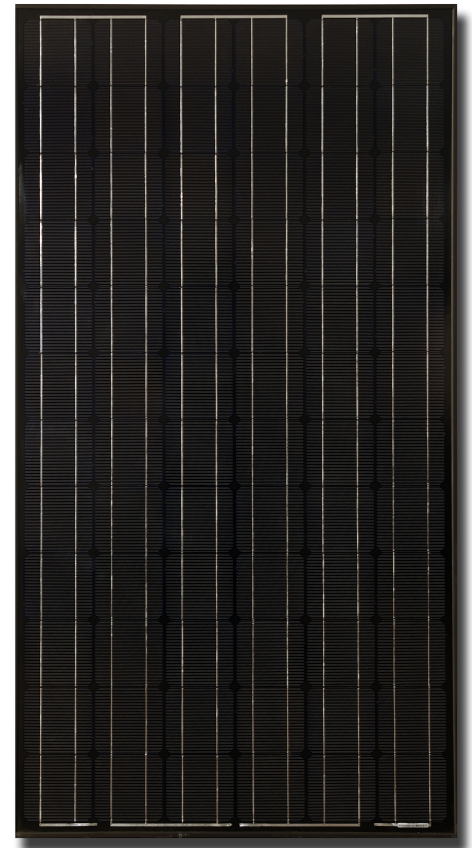

The benefits of this panel:

- » High efficiency up to 16.06 %
- » Highly automated and vertically integrated manufacturing process
- » Output guarantee of 25 years
- » Europe-wide references
- » Bankable in Europe



Dimensions of PV module ZXM5(BK) -72/ 180-205 W

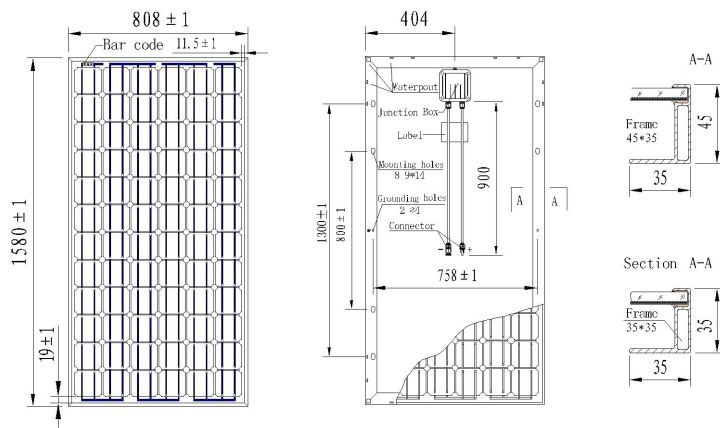

I-V Curves of PV module ZXM5(BK) -72/180-205 W

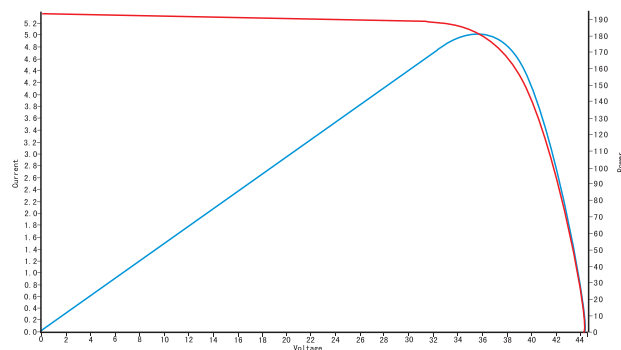

Electrical Data

ZXM5(BK)-72-180/MS ZXM5(BK)-72-185/MS ZXM5(BK)-72-190/MS ZXM5(BK)-72-195/MS ZXM5(BK)-72-200/MS ZXM5(BK)-72-205/MS

Peak Power Watts-P _{MAX} (WP)	180	185	190	195	200	205
Power Output Tolerance-P _{MAX} (%)	0 ~ +3	0 ~ +3	0 ~ +3	0 ~ +3	0 ~ +3	0 ~ +3
Maximum Power Volatage V _{MAX} (V)	36.20	36.40	36.65	36.90	37.30	37.55
Maximum Power Current-I _{MPP} (A)	4.97	5.08	5.18	5.28	5.36	5.46
Open Circuit Voltage-V _{OC} (V)	44.60	45.00	45.36	45.50	45.65	45.75
Short Circuit Current-I _{SC} (A)	5.47	5.54	5.58	5.63	5.65	5.70
Module Efficiency η _m (%)	14.10	14.49	14.88	15.27	15.67	16.06

Values at Standard Test Conditions STC (Air Mass AM1.5, Irradiance 1000 W/m², Cell Temperature 25°C)

Mechanical Data

Solar cells	Mono 125 x 125 mm , (φ165)
Cells orientation	72 (6 x 12)
Module dimension	1580 x 808 x 45 mm , 1580 x 808 x 35 mm
Weight	16 kg / 15.5 kg
Glass	High transperancy, Low Iron, Tempered glass 3.2 mm
Frame	Anodized aluminium alloy
Junction box	IP 65
Cables/Connector	Diameter 4 mm ² , Length 900 mm.
Number of Diodes	3
Colour	Black Frame , White Backsheet / Black Frame, Black Backsheet

Temperature Ratings

Nominal Operating Cell Temperature (NOCT)	45°C (±2°C)
Temperature Coefficient of P _{MPP}	- 0.42 %/°C
Temperature Coefficient of V _{OC}	- 0.29%/°C
Temperature Coefficient of I _{SC}	0.04 %/°C

Working Conditions

Maximum System Voltage	DC1000V (TUV)
Operating Temperature	(-40 ~ +85) °C
Maximum Series Fuses	10 A
Front & rear static load test(eg: wind)	2400 pa
Front load test (eg: snow)	5400 pa

Warranty information

- 10 years workmanship warranty
- 10 years warranty, 90 % power output
- 25 years warranty, 80 % power output

Packaging information

Modules per box	26 / 30 pcs
Modules per pallet	52 / 60 pcs
Modules per 40" HQ container	728 / 840 pcs

ZNSHINE PV-Tech Co., Ltd

#1 Zhixi Industry Zone
Jintan, Jiangsu Province, 213251
People's Republic of China

Tel: +86 519 8244 9178
Fax: +86 519 8244 9170
Email: service@znshinesolar.com